

Aluminium
Stainless steel Letter plates

Technical information	166
Overview	167
Letter plates	168
Intercom and bell-push plates	174
Accessories	176

Letter plates

Letter plates

Letter plates and matching accessories are available for any number of applications and with a great variety of outer and aperture dimensions:

Letter plates with and without spacer.

Letter plates with spring mechanism – they can also be fitted vertically.

Letter plates with nameplates.

DIN 32 617

The Federal German Post Office has, in consultation with letter-plate manufacturers and consumer organisations, drawn up 'industrial guidelines for domestic letter boxes (specifications, testing and installation)'. These guidelines recommend that:

The aperture should be wide enough to allow a C4 letter (229 x 324 mm) to pass through lengthwise.

FSB letter-plate models 3829 and 3801 meet this criteria.

Bell pushes and lighting bases

Bell pushes and lighting bases may only be connected to a low voltage circuit, (max. 24 V/40 mA when connected to 8 V).

Overview

Aluminium
 Stainless steel

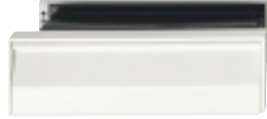

Pages 168 and 169



Page 170



Page 171



Page 172



Page 173



Page 176



Page 176

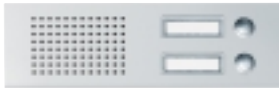

Page 174



Page 174



Page 174



Page 176



Page 175



Page 175



Page 175



Page 176



Letter plates

1



e

Fixing holes :
10 mm Ø, 8 mm deep
5,5 mm Ø through

Installation with delivered
screws M5.

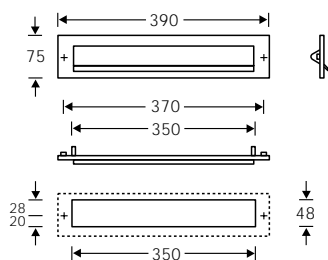
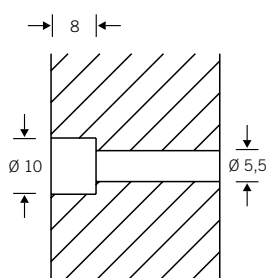

3801

Aluminium

2001 without nameplate
2002 with nameplate

Opening size 325 x 32 mm
Cutout size in the door
350 x 48 mm

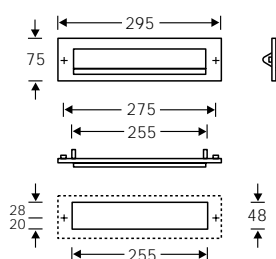

3804

Aluminium

2001 without nameplate
2002 with nameplate

Opening size 230 x 32 mm
Cutout size in the door
255 x 48 mm

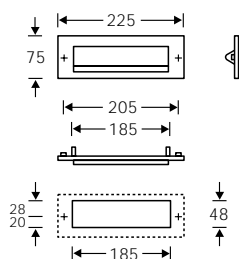

3805

Aluminium

2001 without nameplate
2002 with nameplate

Opening size 160 x 32 mm
Cutout size in the door
185 x 48 mm

Letter plates



Letter plates 3801, 3804 and 3805 are fitted with springs and can hence be installed vertically.

Fixing holes :
10 mm Ø, 8 mm deep
5,5 mm Ø through

Installation with delivered screws M5.

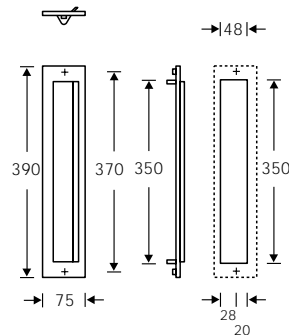
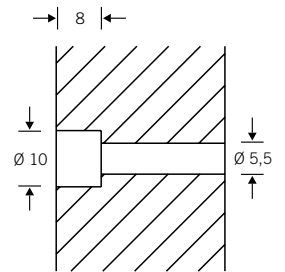

3801

Aluminium

2001 without nameplate
2002 with nameplate

Opening size 325 x 32 mm
Cutout size in the door
350 x 48 mm

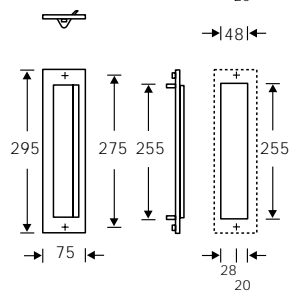

3804

Aluminium

2001 without nameplate
2002 with nameplate

Opening size 230 x 32 mm
Cutout size in the door
255 x 48 mm

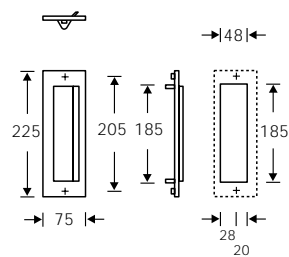

3805

Aluminium

2001 without nameplate
2002 with nameplate

Opening size 160 x 32 mm
Cutout size in the door
185 x 48 mm

Letter plate

1



e

3808

Stainless steel

Opening size 230 x 35 mm
Cutout size in the door
246 x 60 mm

Concealed fixing from the inside or through the inner flap.

Letter plate system 3808 is available as:

- Letter plate set with black spacer and inner flap for door thickness 40 -70mm or door thickness 71-100mm

- Single as letter plate or for wallmounting. Information on fixing page 174.

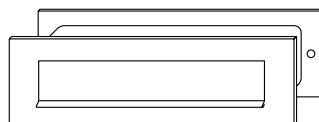

3808 0061 (40 - 70 mm)
3808 0071 (71 - 100 mm)
Letter plate set without nameplate, with spacer and inner flap

3808 0001
3808 0101, wallmounting
Letter plate without nameplate, without spacer or inner flap

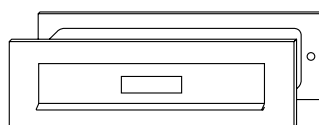

3808 0062 (40 - 70 mm)
3808 0072 (71 - 100 mm)
Letter plate set with nameplate, spacer and inner flap

3808 0002
3808 0102, wallmounting
Letter plate with nameplate, without spacer or inner flap

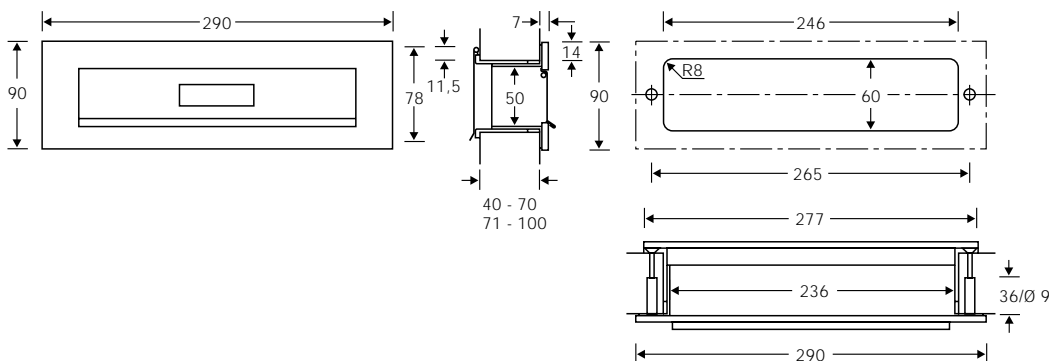

Fixing holes:
9 mm Ø, 36 mm deep
4,5 mm Ø through

Installation with delivered screws M4.

Letter plate



3835 00

Aluminium

Opening size 230 x 40 mm
Cutout in the door
240 x 50 mm

Fixing of letter plate and inner plate must be made separately.

Letter plate system 3835 00 is available as:

- Letter plate set with black spacer and inner flap for door thickness 40 -70mm or door thickness 71-100mm
- Single as letter plate.

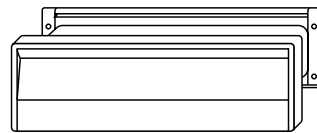

3835 0061 (40 - 70 mm)
3835 0071 (71 - 100 mm)
Letter plate set without nameplate, with spacer and inner flap

3835 0001
Letter plate without nameplate, without spacer or inner flap

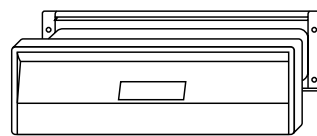

3835 0062 (40 - 70 mm)
3835 0072 (71 - 100 mm)
Letter plate set with nameplate, spacer and inner flap

3835 0002
Letter plate with nameplate, without spacer and inner flap

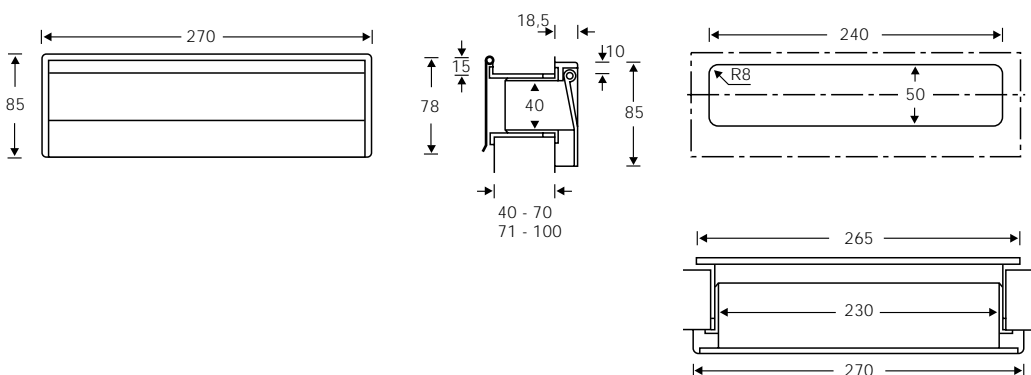

Letter plates

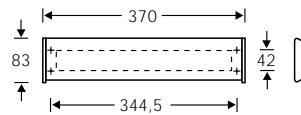

3829

Aluminium

0001 without nameplate
0002 with nameplate

Opening size/cutout size in the door 325 x 40 mm

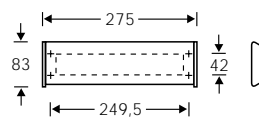

3826

Aluminium

2001 without nameplate
2002 with nameplate

Opening size/cutout size in the door 230 x 40 mm

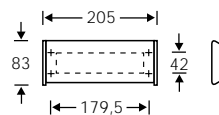

3827

Aluminium

2001 without nameplate
2002 with nameplate

Opening size/cutout size in the door 160 x 40 mm

Letter plate

3826 20

Aluminium
Stainless steel

Opening size 230 x 40 mm
Cutout size in the door
240 x 50 mm

Fixing of letter plate and inner flap must be made separately.



Letter plate system 3826 20 is available as:

- Letter plate set with black spacer and inner flap for door thickness 40 – 70mm or door thickness 71 – 100mm
- Single as letter plate.

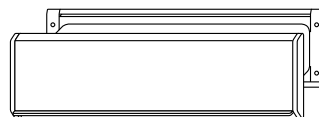

3826 2061 (40 - 70 mm)
3826 2071 (71 - 100 mm)
Letter plate set without nameplate, with spacer and inner flap

3826 2001
Letter plate without nameplate, without spacer or inner flap

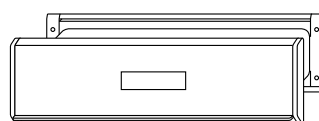

3826 2062 (40 - 70 mm)
3826 2072 (71 - 100 mm)
Letter plate set with nameplate, spacer and inner flap

3826 2002
Letter plate with nameplate, without spacer or inner flap

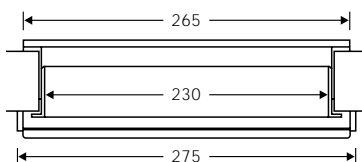
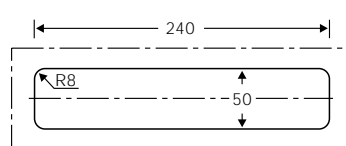
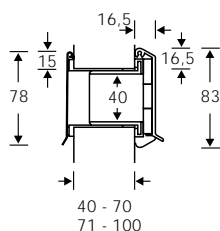
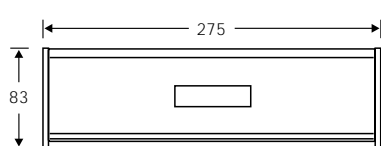

Intercom and bell-push plates

1



3812

Stainless steel

- 0011 single
- 0012 double
- 0111 single, wallmounting
- 0112 double, wallmounting

Mill out size
W 245 x H 70 x D 30 mm

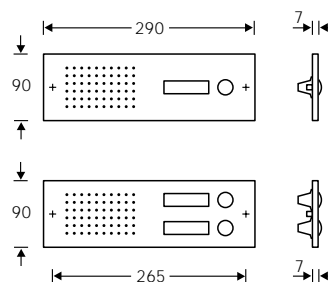

e

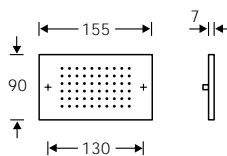
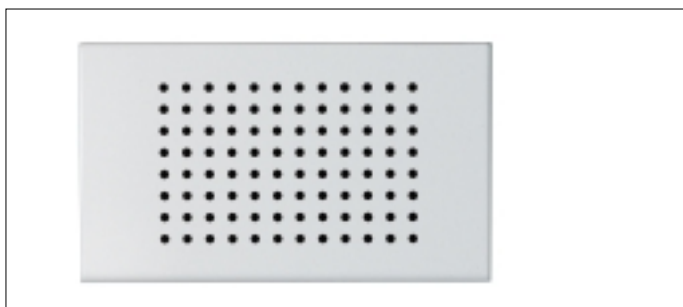

3811

Stainless steel

- 0010 single
- 0110 single, wallmounting

Mill out size
W 110 x H 70 x D 30 mm

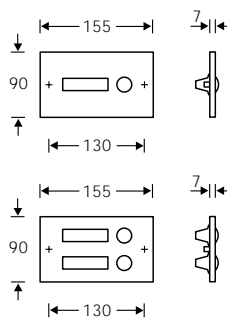

3810

Stainless steel

- 0011 single
- 0012 double
- 0111 single, wallmounting
- 0112 double, wallmounting

Mill out size
W 110 x H 70 x D 30 mm

Instruction:

Bell pushes and lighting bases may only be connected to a low voltage circuit, (max. 24 V/40 mA when connected to 8 V).

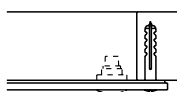
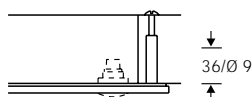

Fixing holes:
9 mm Ø , 36 mm deep
4,5 mm Ø through
Installation with delivered screws M4.

Intercom and bell-push plates and letter plate 3808 are available on request with visible fixing for 5 mm Ø countersunk head screws.

Intercom and bell-push plates



3866

Aluminium
Stainless steel

0011 single
0012 double

Mill out size
W 235 x H 60 x D 30 mm

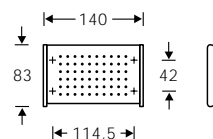
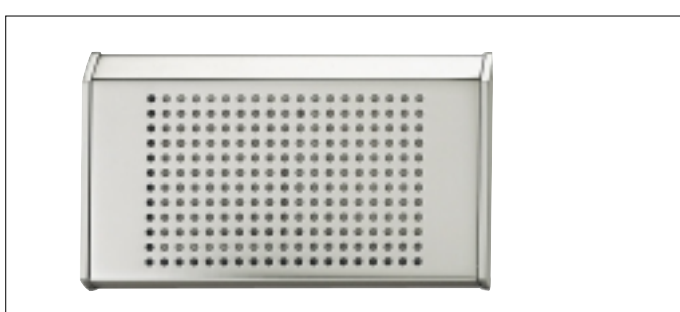
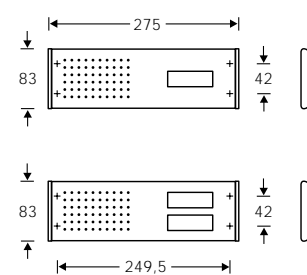

3865

Aluminium
Stainless steel

Mill out size
W 100 x H 60 x D 30 mm

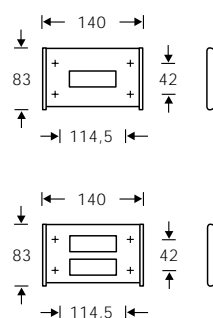

3864

Aluminium
Stainless steel

0011 single
0012 double

Mill out size
W 100 x H 60 x D 30 mm

Instruction:

Bell pushes and lighting bases may only be connected to a low voltage circuit, (max. 24 V/40 mA when connected to 8 V).

Letter hood
Flap
Bell pushes

1

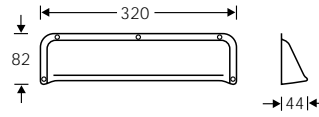

5812

Aluminium

for aperture size
280 x 65 mm

e

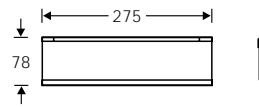

3845

Aluminium

for aperture size
255 x 40 mm

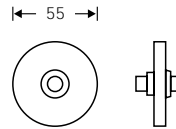

3863

Aluminium

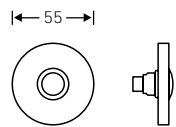

3863

Stainless steel

Instruction:

Bell pushes and lighting bases may only be connected to a low voltage circuit, (max. 24 V/40 mA when connected to 8 V).